

WRU02圆导轨混合滑块 Round rail hybrid blocks



产品特性 Product features

- 标准滚动与滑动混合滑块
 - 顺畅运动且驱动力比标准型下降45%
 - 导向滑动膜标准材料EPB13
 - 抵抗灰尘与无噪音运行
 - 可用于WR系列单轨和双轨
 - 多种安装方式可选
- Rolling and sliding hybrid blocks
 - Smooth moving and driving force reduced 45%
 - Sliding liners material: EPB13
 - Resistant dust and quiet operation
 - For WR single and dual guide rails
 - Various installation options are available

标准规格 Standard specifications

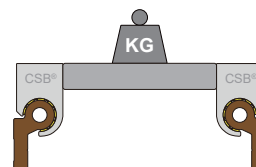
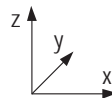
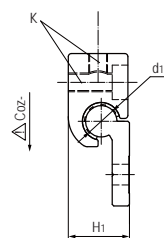
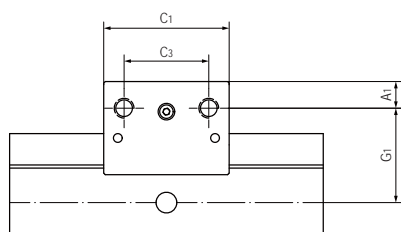

安装方式 Installation Method

产品编码 Part No.	d ₁ [mm]	公差 Tolerance [mm]	C ₁ [mm]	C ₃ [mm]	G ₁ [mm]	A ₁ [mm]	H ₁ [mm]	K [mm]	最大静态载荷 Max. static load [N]	Coz- 最大动态载荷 Max. dynamic load [N]	重量 Weight [g]
WRU02-10	10	+0.088/+0.030	40	27	30.1	8.5	19.5	M6	460	1440	35
WRU02-16	16	+0.088/+0.030	50	34	37.5	11	26.5	M8	680	1760	66
WRU02-20	20	+0.091/+0.030	58	40	42	11	35	M8	960	2480	130

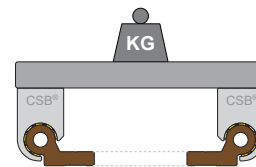
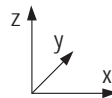
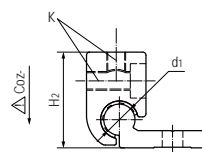
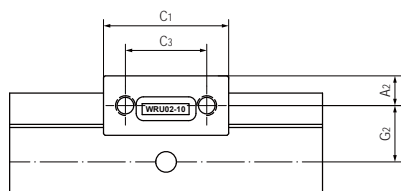

安装方式 Installation Method

产品编码 Part No.	d ₁ [mm]	公差 Tolerance [mm]	C ₁ [mm]	C ₃ [mm]	G ₂ [mm]	A ₂ [mm]	H ₂ [mm]	K [mm]	最大静态载荷 Max. static load [N]	Coz- 最大动态载荷 Max. dynamic load [N]	重量 Weight [g]
WRU02-10	10	+0.088/+0.030	40	27	18	9.5	30.6	M6	460	1440	35
WRU02-16	16	+0.088/+0.030	50	34	19	12.5	41.8	M8	680	1760	66
WRU02-20	20	+0.091/+0.030	58	40	19	16.8	52	M8	960	2480	130